

Acreeage Reporting

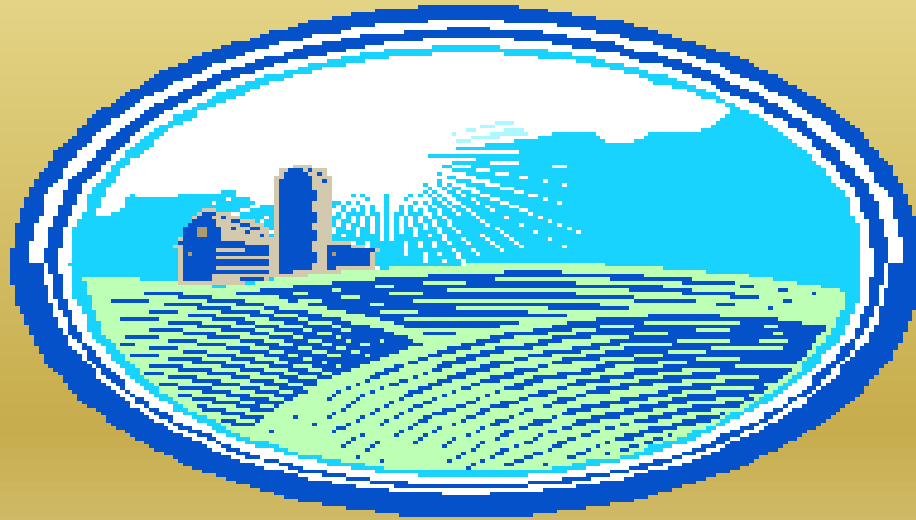

Programs Requiring Reports

- Marketing Assistance Loans and Loan Deficiency Payments
- Farm Storage Facility Loans
- Conservation Reserve Program
- Non-insured Crop Disaster Assistance Program
- Emergency Assistance for Livestock, Honeybees, and Farm-Raised Fish
- Tree Assistance Program

Program Overview

- Filing an accurate and timely report for all crops and land uses, including prevented and failed plantings, can prevent loss of benefits for FSA programs.

Accuracy of Acreage Reporting

- Acreage Variance is the number of acres that the actual planted acres may differ from the reported acres without either of the following:
 1. Total loss of benefits for some programs
 2. Overall accuracy of the report being questioned

Who Can File

- The farm operator
- The farm owner
- Person authorized by power of attorney
- Tenants and share-croppers

Information Needed

- Crop
- Crop type / variety
- Intended use
- Acres planted
- Boundaries of crop
- Non-irrigated/irrigated
- Plant dates

Acreeage Report

Rockingham, New Hampshire

FSA - 578 (02-01-91)

Farm Number: xxx

Operator Name and Address

Joe Farmer
123 Street
Anywhere, USA 00000

PROGRAM YEAR: 2014

DATE: 2-3-2014
PAGE: 1

Original: _____
Revision: _____
Cropland: 69.98
Farmland: 129.28

REPORT OF COMMODITIES FARM AND TRACT DETAIL LISTING

Tract Number	CLU/Field	Crop/Commodity	Variety/Type	Irr Prc	Int Use	Actual Use	Land Use	C/C Status	Reporting Unit	Reported Quantity	Determined Quantity	Crop Land	Field ID	Official/Measured	Planting Date	Planting Period	End Date
154	1	MIXFG	LGM	N	FG			I	A	1.06		Yes		RO	5-1-1982	01	2016
		Producer	Joe Farmer						Share 100.00			RMA Unit				NAP Unit 17	
3A		MIXFG	LGM	N	LS			I	A	0.20		Yes		RO	10-1-2009	01	2020
		Producer	Joe farmer						Share 100.00			RMA Unit				NAP Unit 1050	
3B		CANBR	RED	N	FH		F	I	A	0.05		Yes		RO	5-2-2000	01	2020
		Producer	Joe farmer						Share 100.00			RMA Unit				NAP Unit 1050	
3C		BLUBR	HBS	N	FH		F	I	A	0.20		Yes		RO	5-20-2004	01	2020
		Producer	Joe Farmer						Share 100.00			RMA Unit				NAP Unit 1050	
4		MIXFG	LGM	N	FG			I	A	12.27		Yes		RO	10-1-2003	01	2015
		Producer	Joe Farmer						Share 100.00			RMA Unit				NAP Unit 17	
5		MIXFG	LGM	N	GZ			I	A	13.60		Yes		RO	5-1-1994	01	2015
		Producer	Joe farmer						Share 100.00			RMA Unit				NAP Unit 17	
6		MIXFG	LGM	N	GZ			I	A	42.30		Yes		RO	5-1-1980	01	2015
		Producer	Joe farmer						Share 100.00			RMA Unit				NAP Unit 17	

Cr/Co	Var/Type	Irr Prc	Int Use	Non-Irrig	Irrigated	Cr/Co	Var/Type	Irr Prc	Int Use	Non-Irrig	Irrigated	Cr/Co	Var/Type	Irr Prc	Int Use	Non-Irrig	Irrigated
MIXFG	LGM	N	GZ	55.90		BLUBR	HBS	N	FH	0.20		CANBR	RED	N	FH	0.05	
MIXFG	LGM	N	FG	13.33		MIXFG	LGM	N	LS	0.20							

Photo Number/Legal Description: Not Applicable

Cropland: 69.98

Reported on Cropland: 69.68

Difference: -0.30

Reported on Non-Cropland: 0

FSA - 578 (02-01-91)

**REPORT OF COMMODITIES
FARM SUMMARY**

DATE: 2-3-2014
PAGE: 2

Farm Number: xxx

Original: _____

Operator Name and Address

Revision: _____

Joe Farmer
123 Street
Anywhere, USA 00000

Cropland: 69.98
Farmland: 129.28

NOTE: The authority for collecting the following information is Pub.L. 107-76. This authority allows for the collection of information without prior OMB approval mandated by the Paperwork Reduction Act of 1995. The data will be used to determine eligibility for assistance. Furnishing the data is voluntary, however, without it assistance cannot be provided. The data may be furnished to any agency responsible for enforcing the provisions of the Act.

Producer Name				C/C	Share	C/C	Share	C/C	Share	C/C	Share
Joe Farmer				CANBR	100.00	BLUBR	100.00	MIXFG	.29		
				MIXFG	99.71						

Crop/Commodity	Variety/Type	Irrigation Practice	Intended Use	Reported Quantity	Determined Quantity	Crop/Commodity	Variety/Type	Irrigation Practice	Intended Use	Reported Quantity	Determined Quantity
OFAV		N		0.25		MIXFG	LGM	N	GZ	55.90	
BLUBR	HBS	N	FH	0.20		CANBR	RED	N	FH	0.05	
MIXFG	LGM	N	FG	13.33		MIXFG	LGM	N	LS	0.20	

CERTIFICATION: I certify to the best of my knowledge and belief that the acreage of crops/commodities and land uses listed herein are true and correct and that all required crops/commodities and land uses have been reported for the farms as applicable. Absent any different or contrary prior subsequent certification filed by any producer for any crop for which NAP coverage has been purchased, I certify that the applicable crop, type, practice, and intended use is not planted if it is not included on the Report of Commodities for this crop year. The signing of this form gives FSA representatives authorization to enter and inspect crops/commodities and land uses on the above identified land. A signature date (the date the producer signs the FSA-578) will also be captured.

Operator's Signature (By)

Date

This program or activity will be conducted on a nondiscriminatory basis without regard to race, color, religion, national origin, sex, age, marital status, or disability.

Acresage Report Map

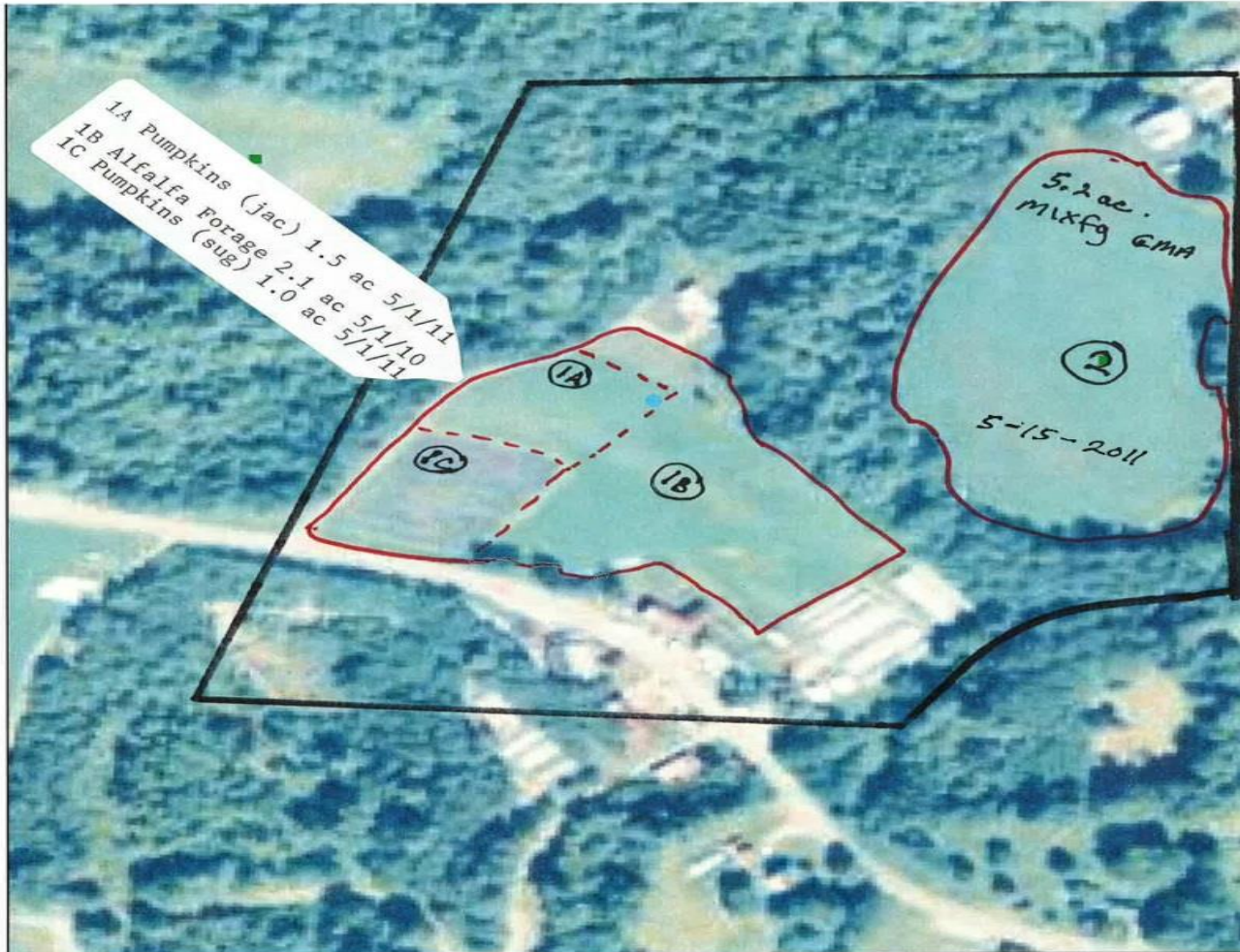

USDA United States Department of Agriculture
Farm Service Agency



Farm #123
Tract #4567

Grafton County
Digital Orthophotography
Not to Scale

Wetland Determination Identifiers

- Restricted Use
- Limited Restrictions
- Exempt from Conservation Compliance Provisions

Disclaimer: Wetland identifiers do not represent the size, shape or specific determination of the area. Refer to your original determination (CPA-026 and attached maps) for exact wetland boundaries and determinations, or contact NRCS.

Acreage Reporting Dates

CROP	Reporting Deadline
Honey	January 2
Apples	January 15
Peaches	
Maple Sap	February 15
Ornamental Nursery	May 31
All other crops	July 15
Fall Forage Seeding	November 15
Fall Seeded Small Grains	

Measurement Services

- A measurement service may be requested by any producer.
- If not required by procedure, a fee will be charged.
- This measurement can be done by a farm visit or in the office.



UNITED STATES
DEPARTMENT OF AGRICULTURE
New Hampshire Farm Service Agency